

DLU200

Touch Screen Driver Display

Robust touch screen driver display designed for a variety of public transport systems

The DLU200 Touch Screen Driver Display is designed for use in a variety of public transport systems.

It combines a high-resolution 480x272 TFT LCD colour display with software adjustable illumination, and a Touch Screen that can be configured in software for single or dual touches. The Touch Screen is fitted with 4mm of toughened glass suitable for use in a transport environment.

The DLU200 contains an open-architecture Linux computer to create a mobile ticket validation solution.

The DLU200 can be connected via Ethernet to a bus computer or modem.



Features

- Robust design for long-term front-line use.
- Touch Screen Display with 4mm toughened glass.
- High Resolution 480x272 TFT LCD colour screen.
- Compact design allows easy incorporation in bus driver cockpit environments where space is at a premium
- Linux computer for integration of ticket validation software

Applications

- Buses
- Ticket Offices



Dimensions

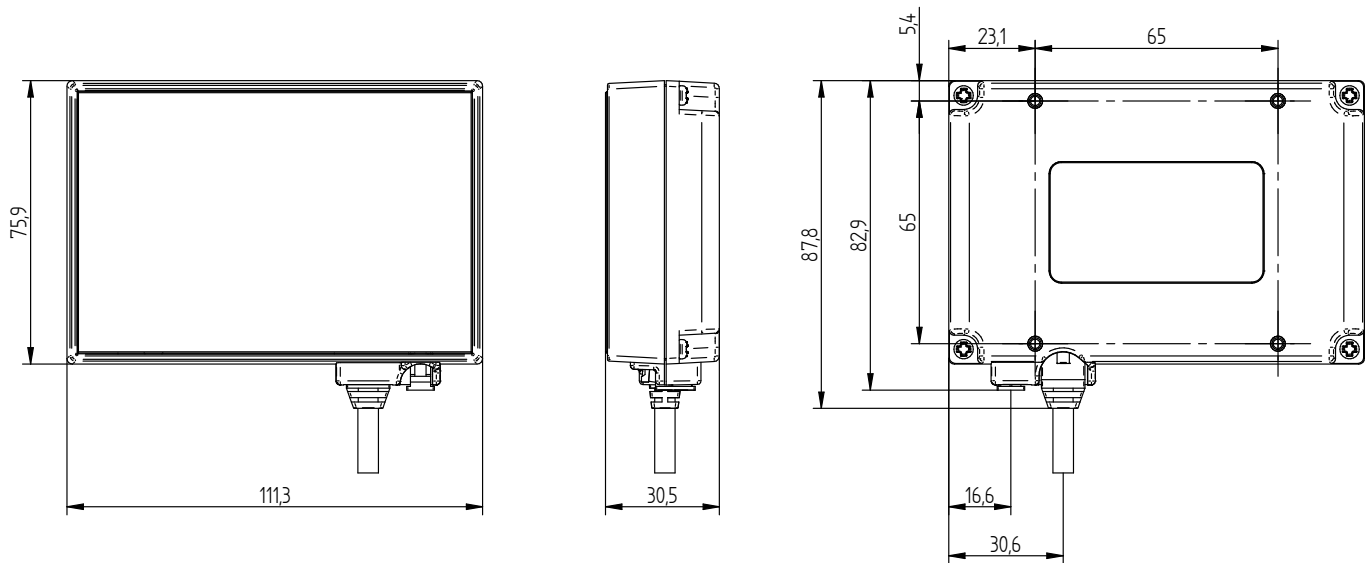

Mechanical

External dimensions:
111.3W x 75.9H x 30.5D mm
Body: Black ABS

Power supply

Input when used with PPU 10 to 34V
less than 20W
Input when not using PPU (NOT
recommended) 9 to 33V less than 20W

Environmental

Temperature: Operating -20°C to
+50°C; Storage -40°C to +70°C
Humidity: 5-90% humidity, non-
condensing
Shock and Vibration: IEC 61373
Fire retardance: EN13501-1
EMC Approvals:
FCC 47CFR Part 15 Class A
EN55032: 2015 Class A
EN 55024:2010 inc A1:2015
EN 301 489-1:V3.2.2
EN 301 489-3:V3.2.0
Canadian Standard ICES-003:Issue 6
UL 60950-1 and CSA C22.2 No. 60950-
1-07
FCC/CFR 47:Part 15:2016 Radiated
emissions
IEC 60950-1 2nd edition
IEC 60950-1 2nd edition including
amendment 1

Safety: EN 60950-1: 2006; IEC 62471:
2006 - Exempt Class
Ingress: IP54
MTBF: 50,000 hours

Communications and host

Wired: 1G Ethernet
Host: dual core ARM9 with 1GB of
RAM, 32GB or 128GB eMMC storage
or single core ARM9 with 512MB RAM,
32GB or 128GB eMMC storage

All trademarks acknowledged. Specifications subject to change without prior notice. This literature is for outline information only.

Ver: 1.0 March 2019



Worldwide: +44 (0) 118 966 3333
Americas: +1 770-645-2771



Worldwide: +44 (0) 118 966 3333
Americas: +1 703-403-6848



Worldwide: +44 (0) 118 966 3333
Americas: +1 484 258 1359



email: sales@access-is.com
18 Suttons Business Park • Reading • RG6 1AZ • UK